



Welcome to
156 & 158 Woodstock Road

— Fredericton —

\$448,500

Anne & Nicole
SMITH



PAN Information

PAN:	865141	Status:	Open
Assessed Owner(s):	LEJEUNE, JASON & TINA & CAROLE	Mailing Address:	156-158 WOODSTOCK RD FREDERICTON NB
Assessment Year:	2018	Postal Code:	E3B 2H5
Current Assessment:	\$307,900	Current Levy:	\$4,050.68
Location:	156-158 WOODSTOCK RD	County:	York
Property Description:	HOUSE & LOT	Tax Class:	Fully Taxable
Property Type Code:	120	Property Type Name:	Residential Improved
Taxing Authority Code:	300	Neighborhood Code:	09
Taxing Authority Description:	City of/Cité de Fredericton	Neighborhood Description:	SUNSHINE GARDENS AND HANWELL ROAD
Sequence Number:	P156	Sub Unit:	1
Harmonization:	COMPLETED (One to one match of parcels)	Farm Land Identification Program:	No
PID:	<u>01438191</u>	PID (2nd):	-
More PID(s):	No		

Sale Price Information

No Records returned

[PAN Report](#)

Parcel Information

PID:	<u>01438191</u>	County:	York
Status:	Active	Active Date/Time:	
Land Related Description:	Land	Management Unit:	NB1501
Area:	920	Area Unit:	Square Metres
Date Last Updated:	2016-07-26 13:43:58	Harmonization Status:	Harmonized
Land Titles Status:	Land Titles	Land Titles Date/Time:	2003-05-28 13:54:35
Date of Last CRO:	2016-07-26 13:44:11	Manner of Tenure:	Joint Tenants
Land Gazette Information:	Yes		

Description of Tenure:

Public Comments:

MAP / CARTE 13L31SW

[View Map](#)

[View Parcel Description](#)

[PID Report](#)

[Land Gazette](#)

Parcel Interest Holders

Name	Qualifier	Interest Type
LeJeune, Carol Elaine		Owner
LeJeune, Jason Elliott		Owner
LeJeune, Tina Lynn		Owner

Assessment Reference

PAN	PAN Type	Taxing Authority Code	Taxing Authority
<u>00865141</u>		300	City of/Cité de Fredericton

Parcel Locations

Civic Number	Street Name	Street Type	Street Direction	Place Name
156	Woodstock	Road		Fredericton
158	Woodstock	Road		Fredericton

County Parish

County	Parish
York	City of/Ville de Fredericton

Documents

Number	Registration Date	Book	Page	Code	Description
36161389	2016-07-26			6110	Discharge of Mortgage
36078096	2016-06-30			5100	Mortgage
32361892	2013-01-22			6110	Discharge of Mortgage
32168131	2012-11-15			5100	Mortgage
29569598	2010-12-07			6110	Discharge of Mortgage
23337737	2007-01-16			5110	Collateral Mortgage
21652798	2006-01-30			6110	Discharge of Mortgage
21523296	2005-12-23			5100	Mortgage
16639834	2003-07-16			6110	Discharge of Mortgage
16343148	2003-06-02			5100	Mortgage
16343114	2003-06-02			1100	Deed/Transfer
16316946	2003-05-28			3800	Land Titles First Notice
16316938	2003-05-28			3720	Land Titles First Order
16316052	2003-05-28			3900	Land Titles First Application
10554781	1999-10-15	2178	160	5100	Mortgage
10554732	1999-10-15	2178	157	1100	Deed/Transfer
202234	1975-09-19	602	765	101	Deed

Plans

No Records returned

Parcel Relations

No Records returned

Non-Registered Instruments

No Records returned



Developed by *caris*

[Back](#) • [Home](#) • [Help](#) • [Problem Report](#)

Tools

- Overview
- Center
- Zoom in
- Zoom out
- Zoom box
- Point Select
- Box Select
- Center Selection
- Clear Selection
- Refresh Map
- Locator Map

Map Layers

- Cadastral
- Topographic
- Legend

Options

Selection Summary

Map

Zoom Factor

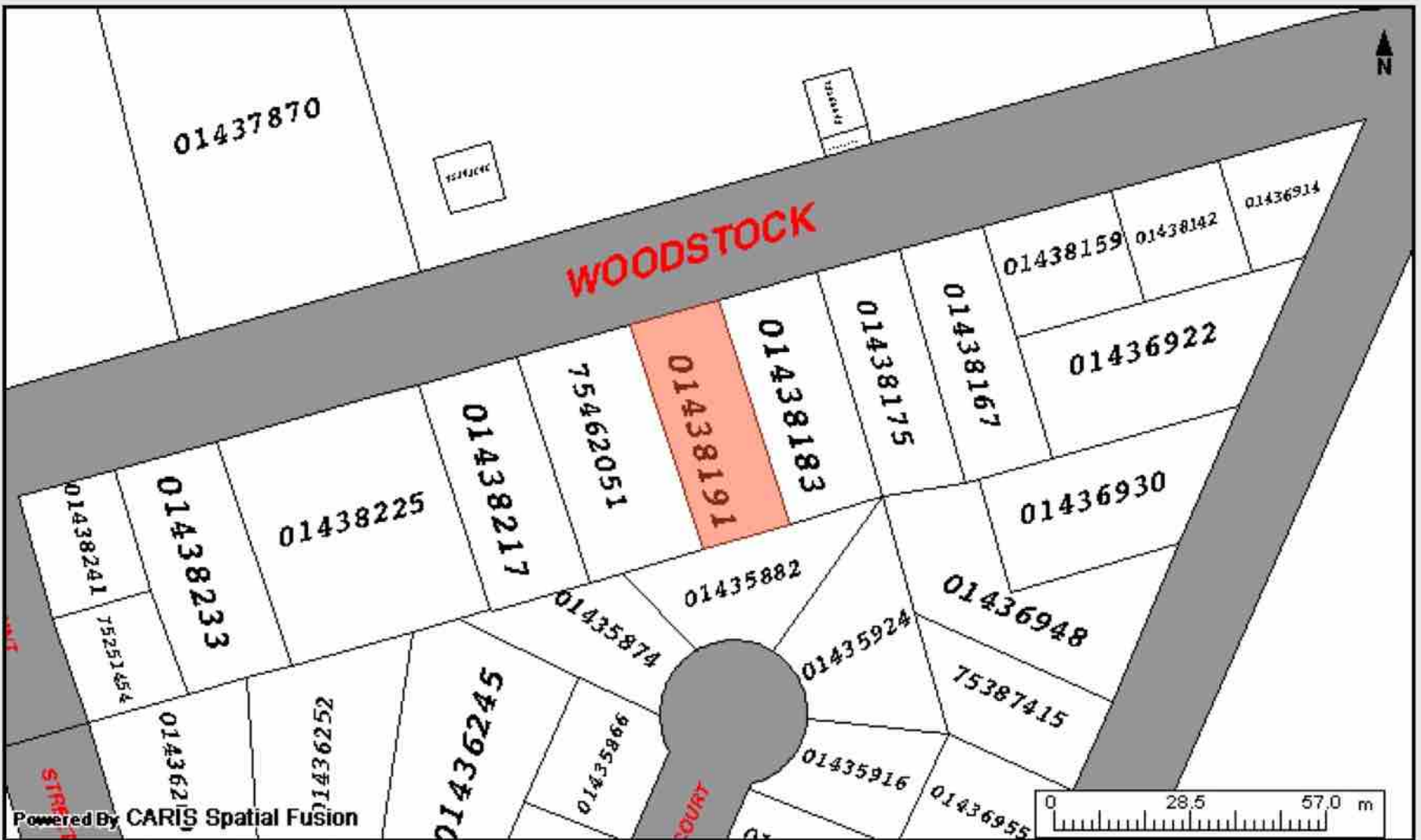

This map is a graphical representation of property boundaries which approximates the size, configuration and location of properties. It is not a boundary survey and is not intended to be used for legal descriptions or to calculate exact dimensions or area.

Lat.: Long.: Scale: 1391 X: Y:



1 Property found

PID	01438191	PAN	865141	Owner	LeJeune, Jason Elliott	Location	156 Woodstock Road
		PAN	865141	Owner	LeJeune, Tina Lynn	Location	156 Woodstock Road
		PAN	865141	Owner	LeJeune, Carol Elaine	Location	156 Woodstock Road
		PAN	865141	Owner	LeJeune, Jason Elliott	Location	158 Woodstock Road
		PAN	865141	Owner	LeJeune, Tina Lynn	Location	158 Woodstock Road
		PAN	865141	Owner	LeJeune, Carol Elaine	Location	158 Woodstock Road

Anne & Nicole
SMITH

nicolesmith@royallepage.ca

506.260.4376

AnneAndNicoleSmith.ca